



Re-Imagining the Garden City

GROWING TOGETHER

C.F. Møller Architects:
Rolf Nielsen
Associate Partner

[C.F. Møller, URBED & HUMAN+NATURE]

HOW SHALL WE LIVE?

It used to be that we were concerned with how to sustain the way we live; now it is more a question of which lifestyles can we sustain. What is clear is that we cannot continue as we are with high-consumption, high-energy, high-waste, out-of-sight-out-of-mind lifestyles. So the question becomes, how can we re-make places to support a transition in which seemingly insoluble problems are seen afresh as great opportunities to live better lives?

GROWING TOGETHER

THE TEAM

We have brought together a team that has collaboration at its heart. Our collective experience and the creativity of our team, combined with our commitment to innovation and design research, allows us to develop environments that respond positively to the challenges of this project.

C.F.Møller

C.F. Møller Architects is one of Scandinavia's leading architectural firms, with 90 years of award-winning work in the Nordic region and worldwide. Through their work, C.F. Møller Architects has helped to shape Danish and Nordic societies' masterplans and housing, with a constant focus on social innovation through architecture. With an established presence in the UK, they have developed local expertise across several sectors, whilst being able to draw upon the knowledge and resources from branches in Scandinavia to deliver major projects.



URBED

URBED is a multi-disciplinary practice that specializes in urban design, master planning, community consultation and sustainability. It has twice won the Urban Design Group Practice of the year and has undertaken successful masterplans throughout the UK. In 2014 the practice won the Wolfson Economics Prize which was focused on Garden Cities. This was for a submission that explored the expansion of a fictional town called Uxcester which has since gone on to be very influential with the government and with many of the places that are part of the Garden Villages, Towns and Cities Program.

Human+Nature

The Human + Nature leadership team draws upon extensive experience of international green cities and city networks, urbanism, urban design and public realm, residential, commercial, leisure and cultural architectures and construction. They have extensive experience in providing analysis, appraisals and modelling innovative deal structures. The team has worked in public/private partnerships with complex funding arrangements and fund raising and have run political, community and wider stakeholder processes for some of the biggest projects in the UK. Human + Nature specialises in assembling bespoke teams for each job and in running a sound process to get the best results in terms of design, buildability, cost-efficiencies and indeed value - especially over the long term.





The New Garden City

The Garden City for the 21st century must focus on community creation

The links between productive and performance landscapes, sustainable and amenity landscapes, homes and community infrastructure create a key synergy that must be communicated with a strong vision

GROWING TOGETHER
THE FRAMEWORK



GROWING TOGETHER

THE APPROACH



Local green infrastructure, Greenway

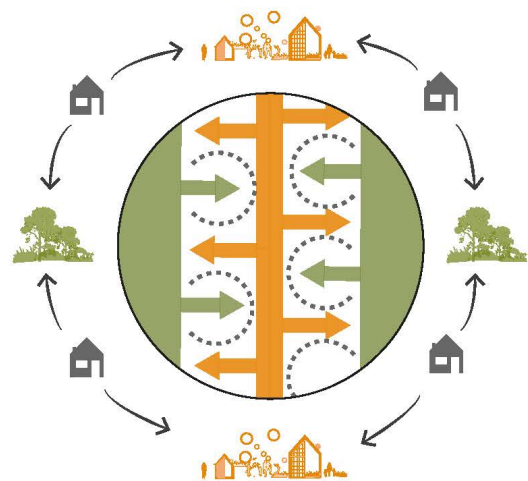

Landscape & town intertwined

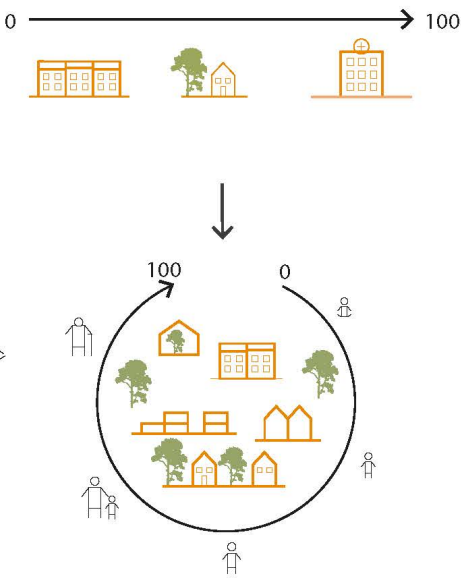
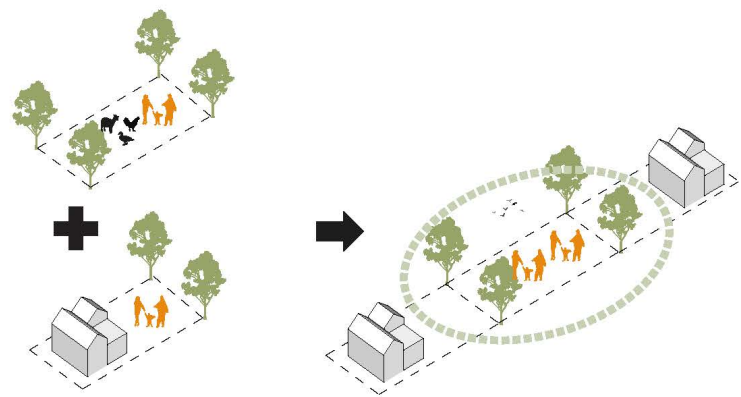

A community for the whole life

FOOD PRODUCTION

WHY AGRO-FORESTRY?

- Sharp decline in UK soils nutrient level - 100 harvests left.
- Sharp decrease in overall biodiversity.
- Reduced tree cover (12%) when comparing to Europe's 44%.
- Increase of 34% in carbon sequestration, when comparing to regular farming.

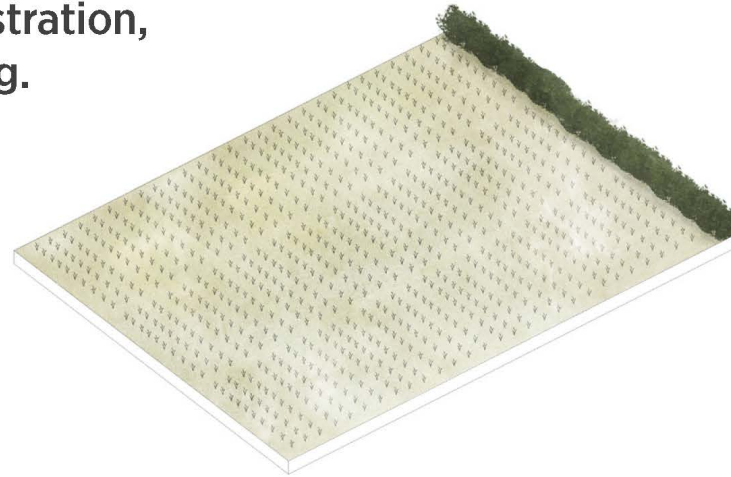

FROM A GREEN DESERT

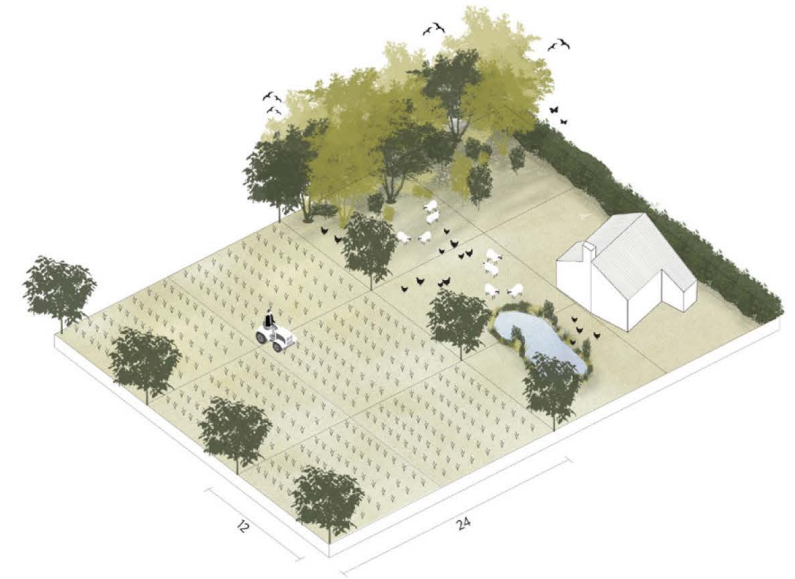

TO A COMPLEX AND REGENERATIVE
SYSTEM

FOOD PRODUCTION

A COMPLEX AND REGENERATIVE SYSTEM

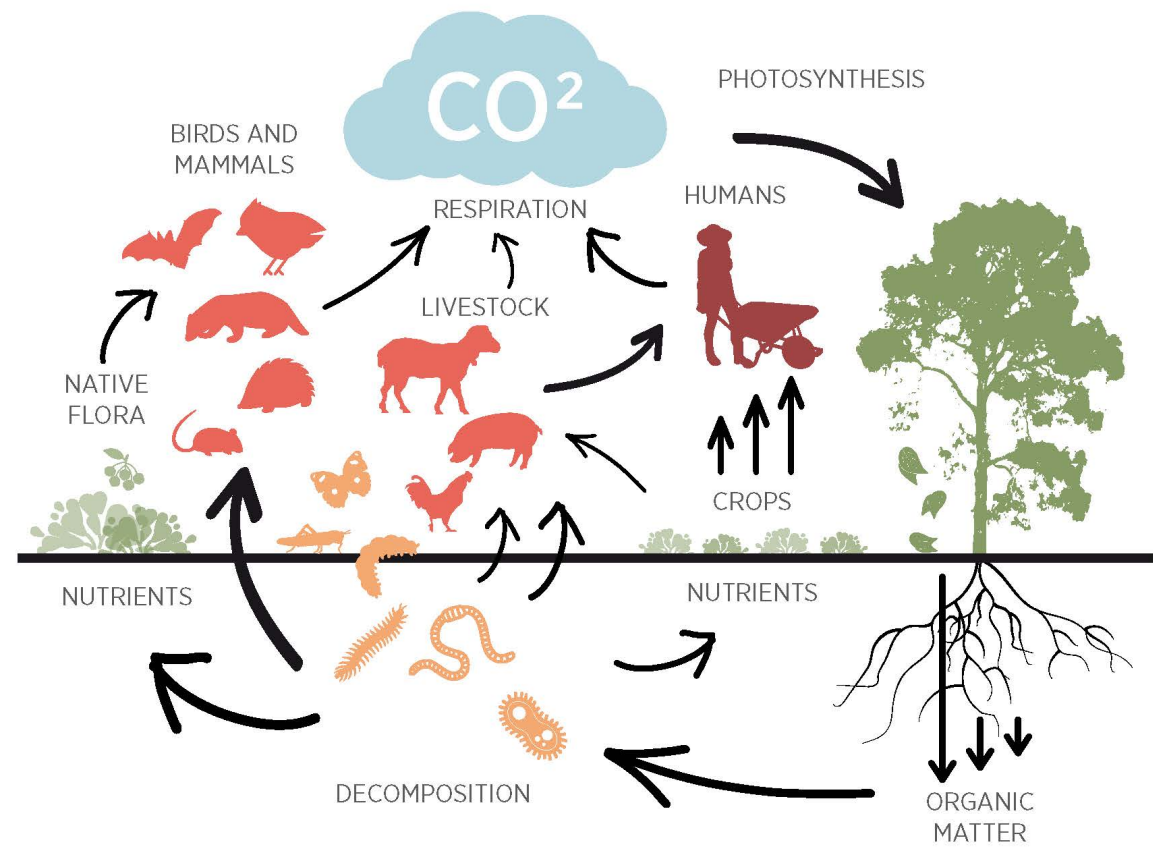

CARBON CYCLE

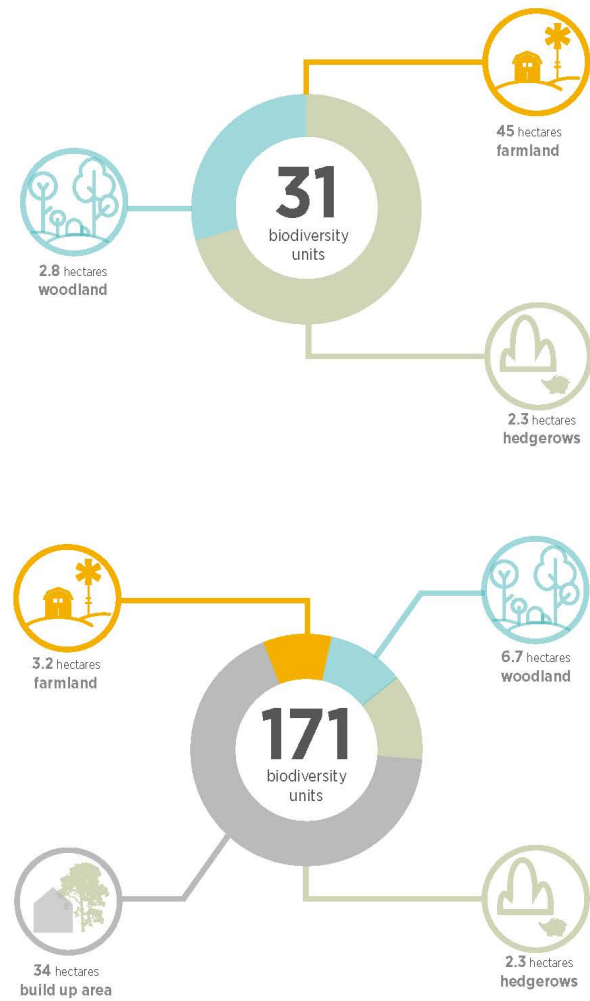

BIODIVERSITY NET GAIN

FOOD PRODUCTION
BACK TO BASICS

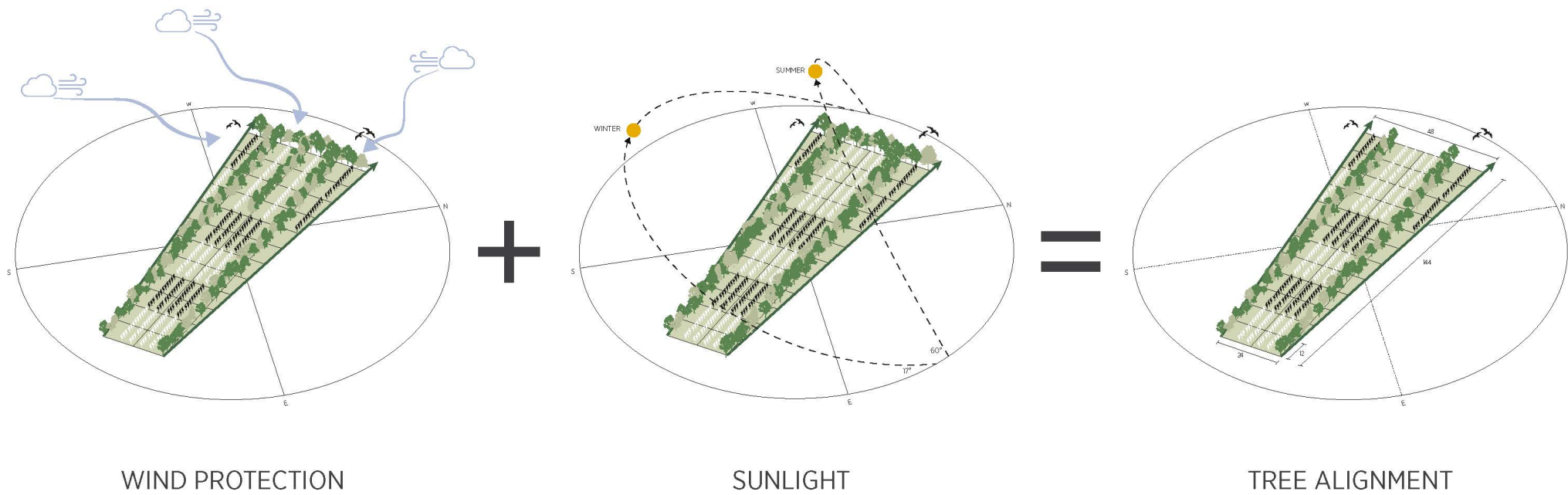

FOOD PRODUCTION
LAYERS AND CROP ROTATION

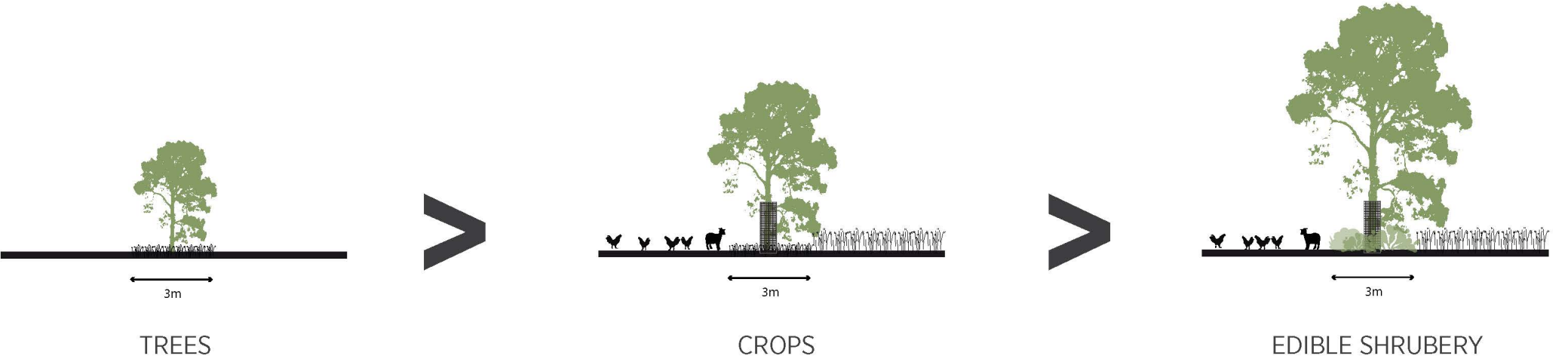

FOOD PRODUCTION

GROWING A COMMUNITY

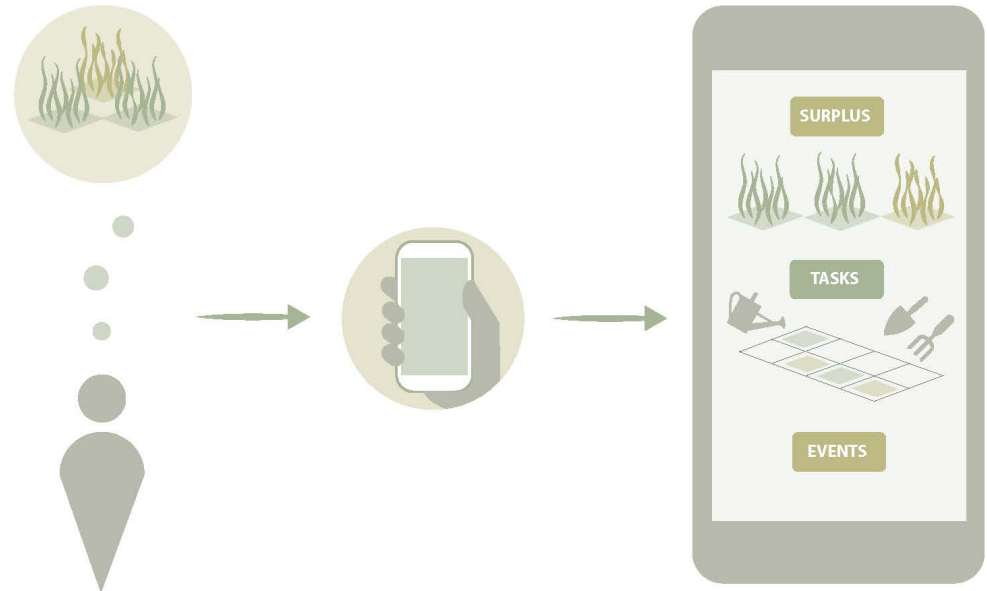
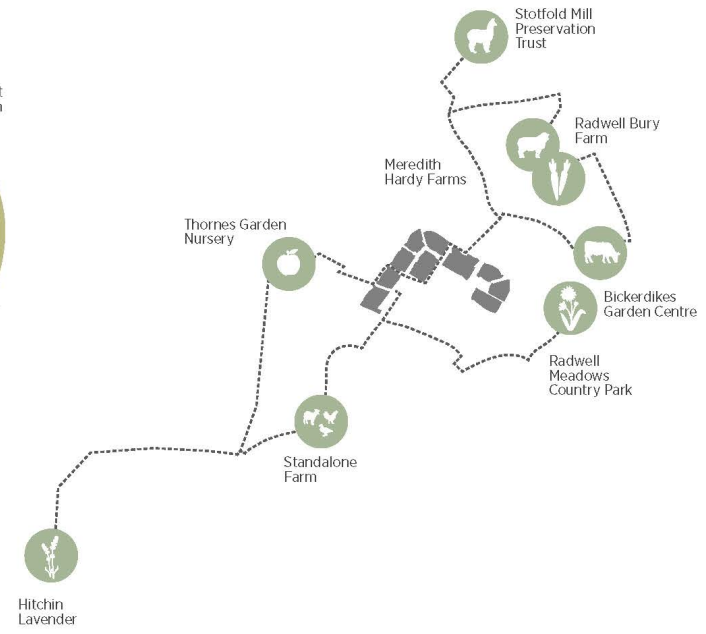
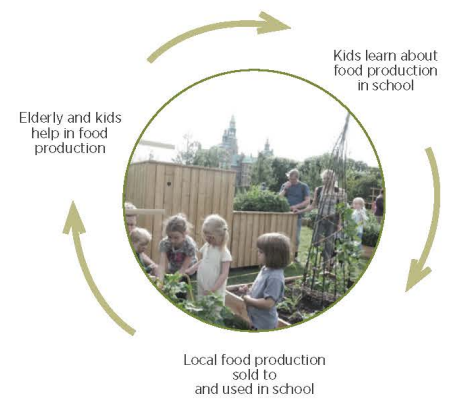
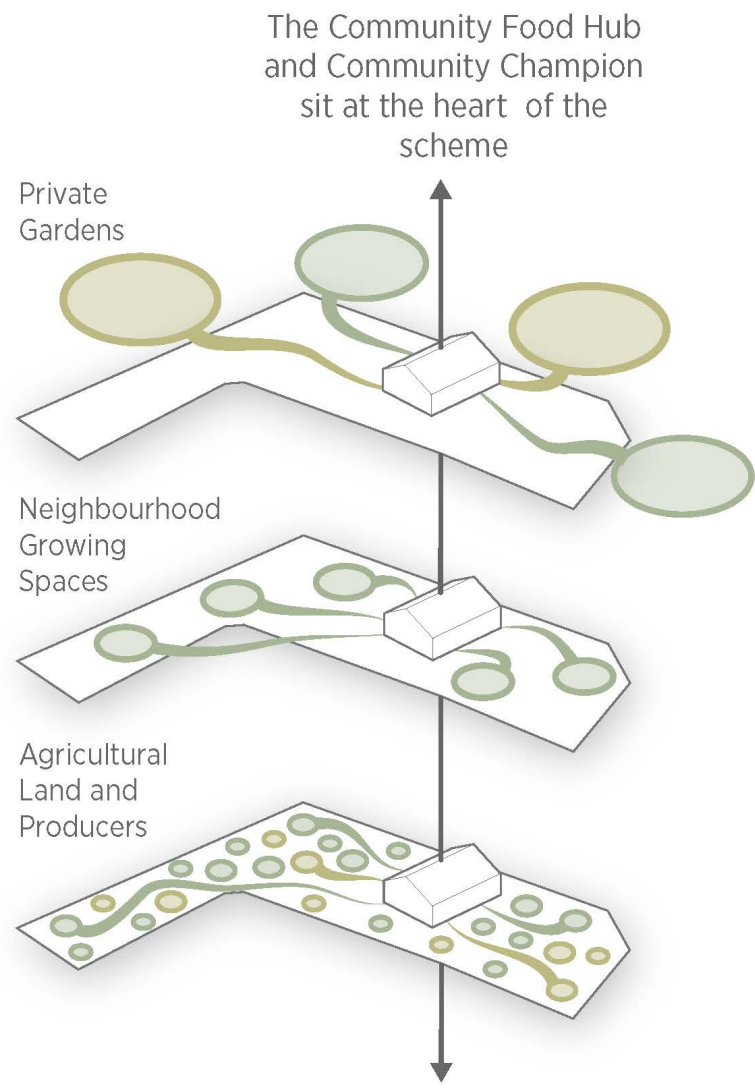

HOMES AND COMMUNITY STRUCTURES

THE FLEXIBLE STRUCTURES

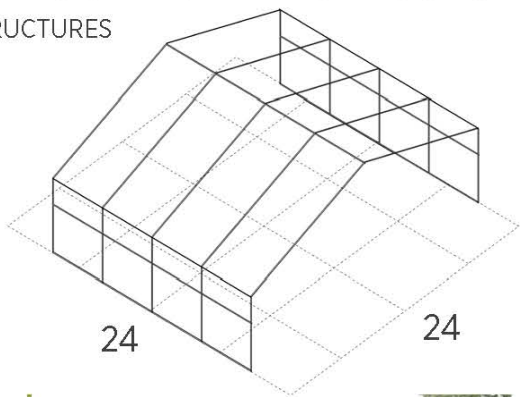

Through-out the masterplan these flexible structures can be used for a multiple of activities from parking, community growing, nurseries & sport activities. These structures can be completely open or more closed.



Activities Palette



Workshop



Turning Earth



Training



Skatepark



Community factory



Tree top walk



Education



Events



LANDSCAPE

THE GREEN FRAMEWORK

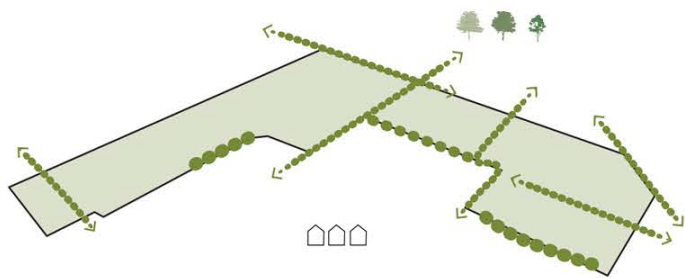

Step 01 - The Greenway and existing hedgerows define the overall structure.

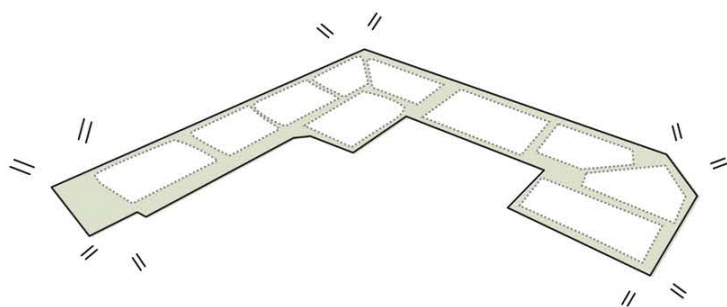

Step 02 - Site is divided up in rational development plots based on around 90-100 dwellings per Hamlet.

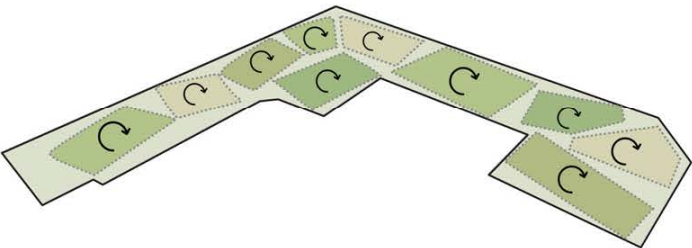

Step 03 - The development plots are rotated to give each Hamlet an individual character, creating a varied experience along the main Avenue.

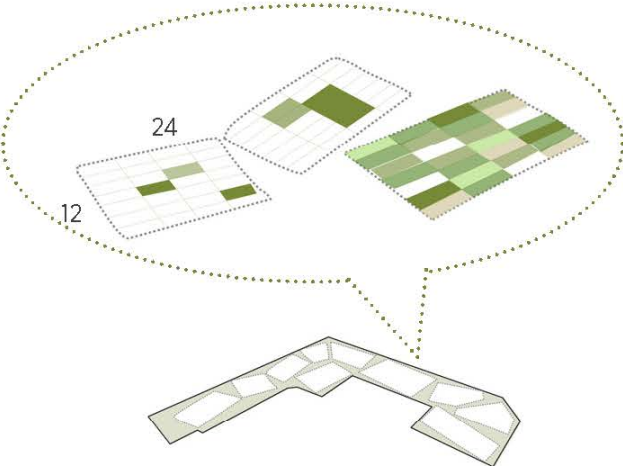
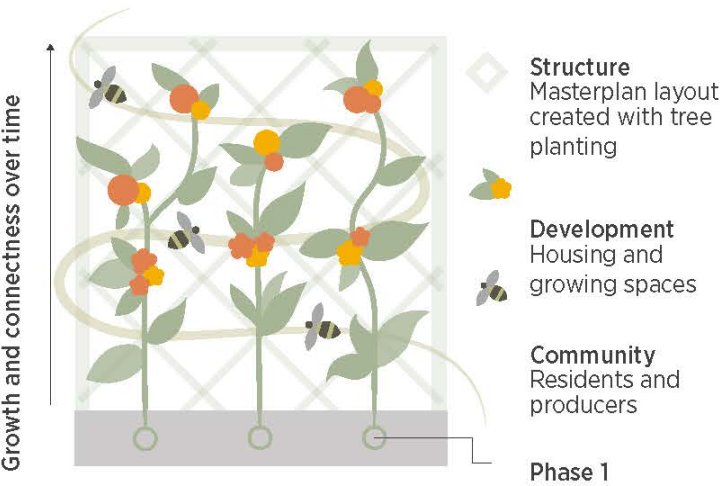

Step 04 - Each development plot is subdivided into standard plots of 12m wide by 24m deep.

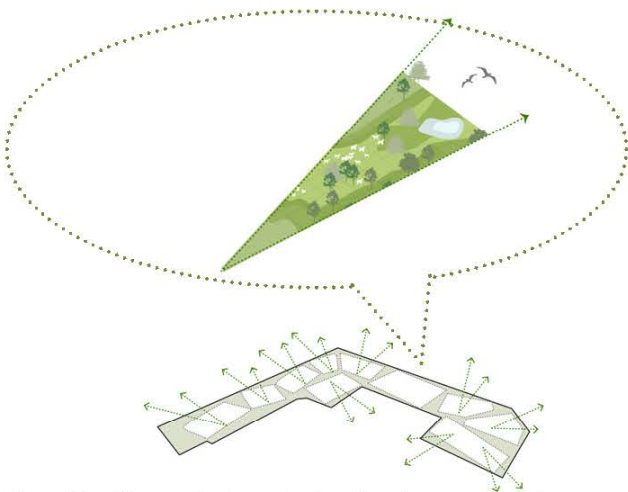

Step 05 - The central productive landscape in each Hamlet creates view corridors ensuring close connection with the surrounding landscape for local residents and the wider community along the Greenway.

SUSTAINABLE DRAINAGE SYSYSTEMS

THE BLUE INFRASTRUCTURE

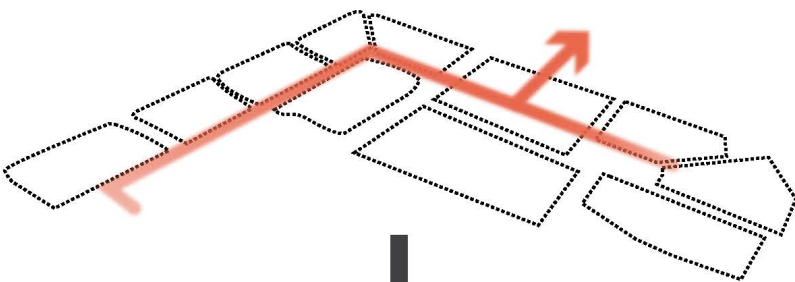

THE AVENUE AS THE MAIN SOURCE OF POLLUTION

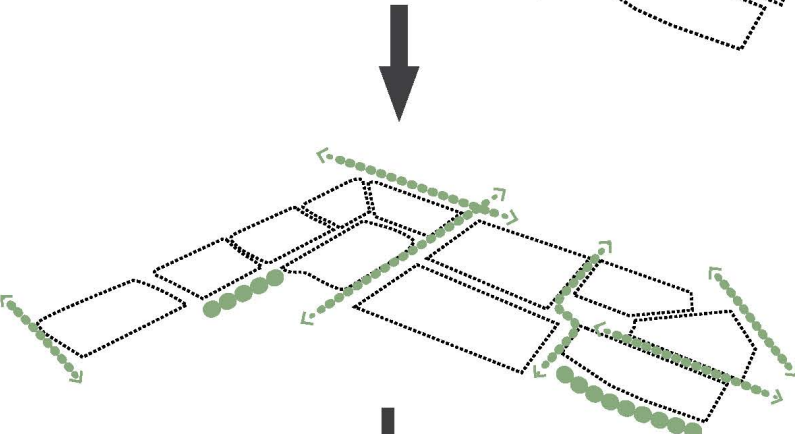

EXISTING GREEN INFRASTRUCTURE

+

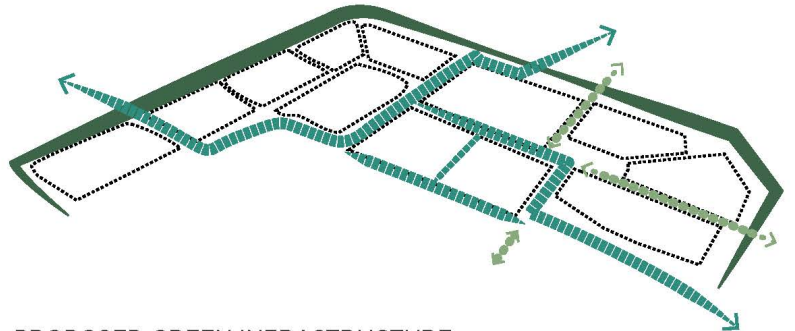

PROPOSED GREEN INFRASTRUCTURE INTEGRATING HEDGEROWS

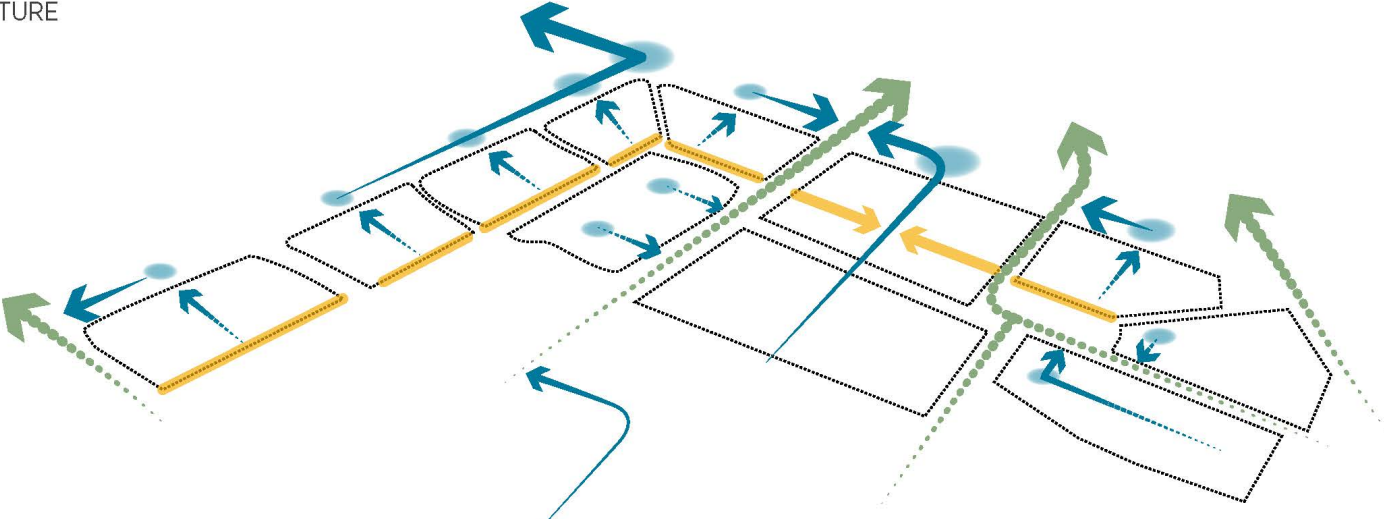

PROPOSED SUDS STRUCTURE

LANDSCAPE

THE GREEN INFRASTRUCTURE/ TOWN & COUNTRY

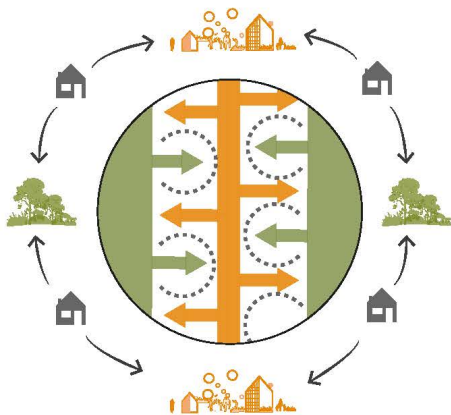

COUNTRY

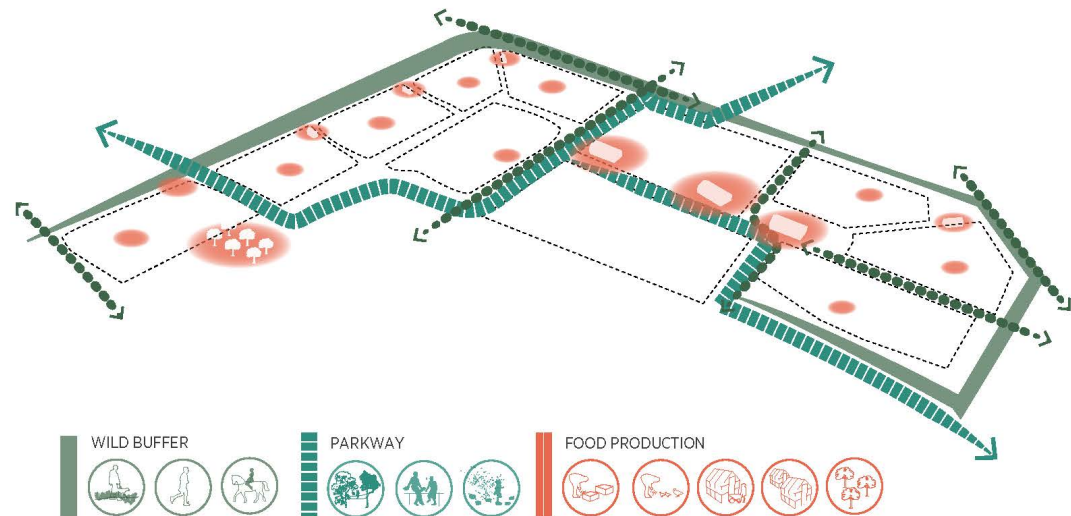

TOWN

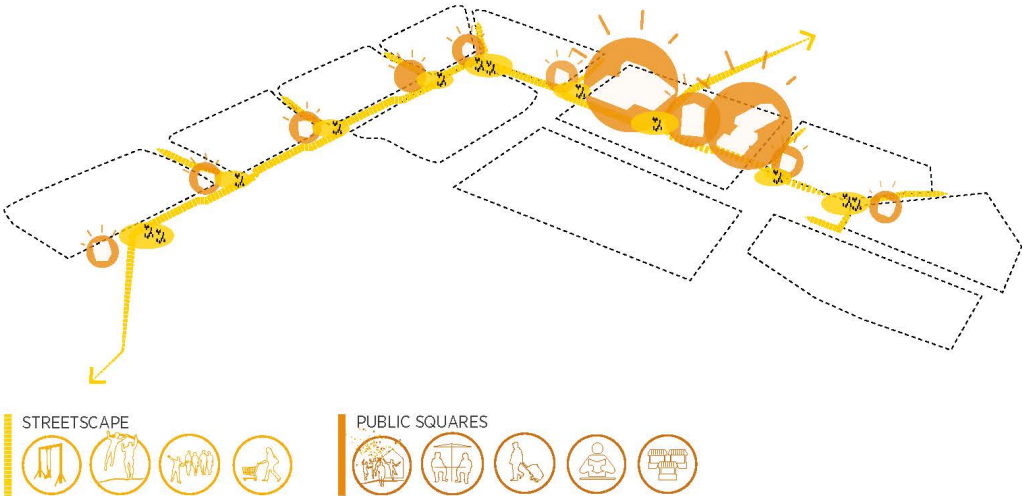

- | | | | |
|---|----------------------------------|---|----------------------------------|
| A | HAMLET | N | TRANSPORT HUB |
| B | MEADOW | O | SCHOOL |
| C | PONDS | P | CARE CENTRE/
SENSORY GARDENS |
| D | CAR-FREE MEWS | Q | SELF-BUILD |
| E | SHARED PARKING | R | FLEXIBLE STRUCTURES
(PARKING) |
| F | COMMUNAL SQUARE | | |
| G | AVENUE | | |
| H | COMMUNITY FARM /
AGROFORESTRY | | |
| I | RAIN GARDENS | | |
| J | HEDGEROWS | | |
| K | PARKWAY | | |
| L | ORCHARDS | | |
| M | WILD BUFFER | | |





Growing a Neighbourhood

Within a regulated framework of blocks and plots we are creating conditions in which a neighborhood can grow and evolve organically.

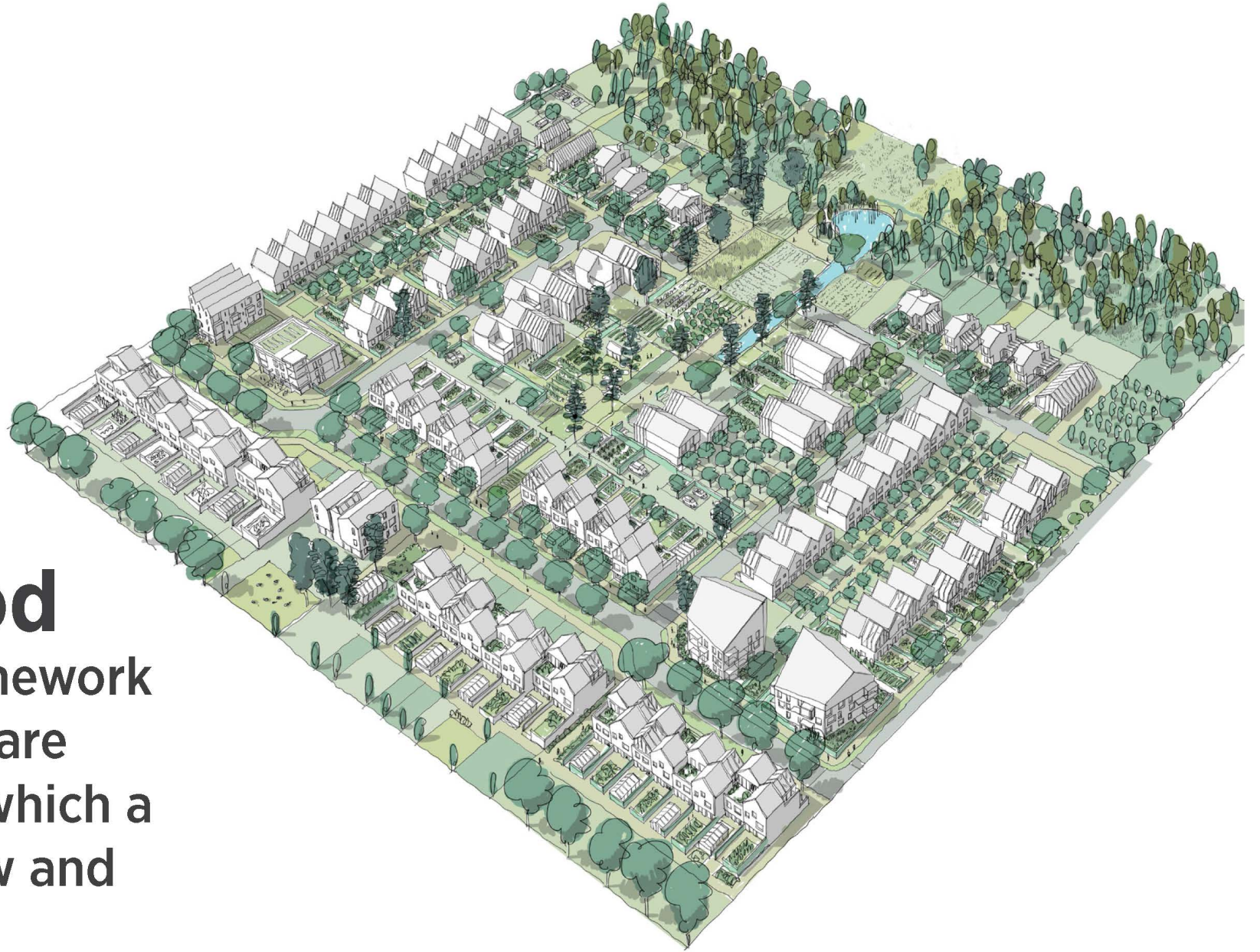

GROWING TOGETHER
THE GREEN INFRASTRUCTURE



framework

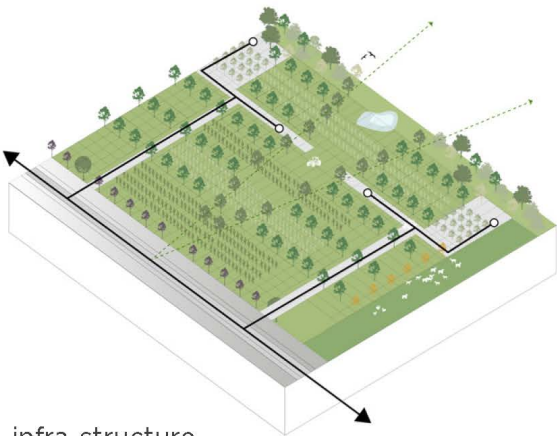

infra-structure



masterplan

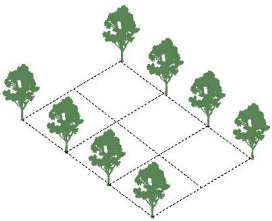

hamlet

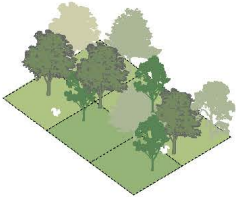

wild buffer

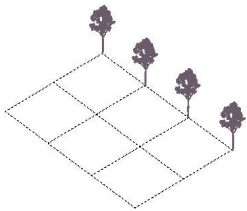

street trees

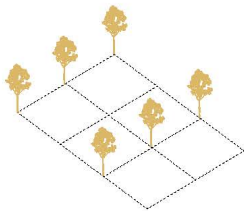

mews

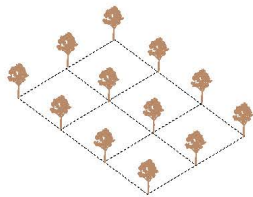

orchard

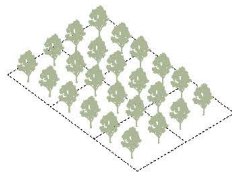

car park

GROWING TOGETHER

THE GREEN INFRASTRUCTURE

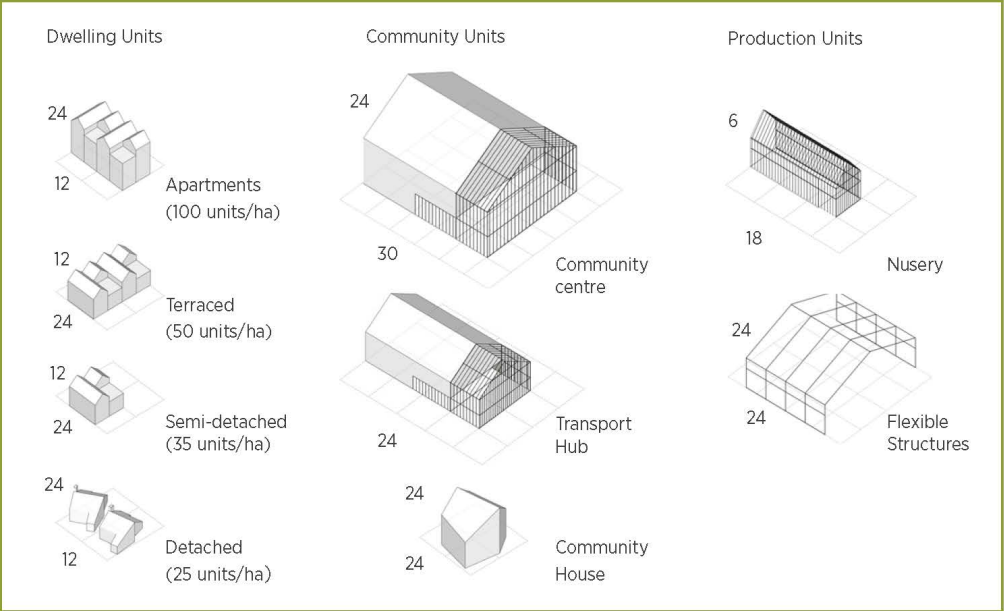

The Framework - Elements

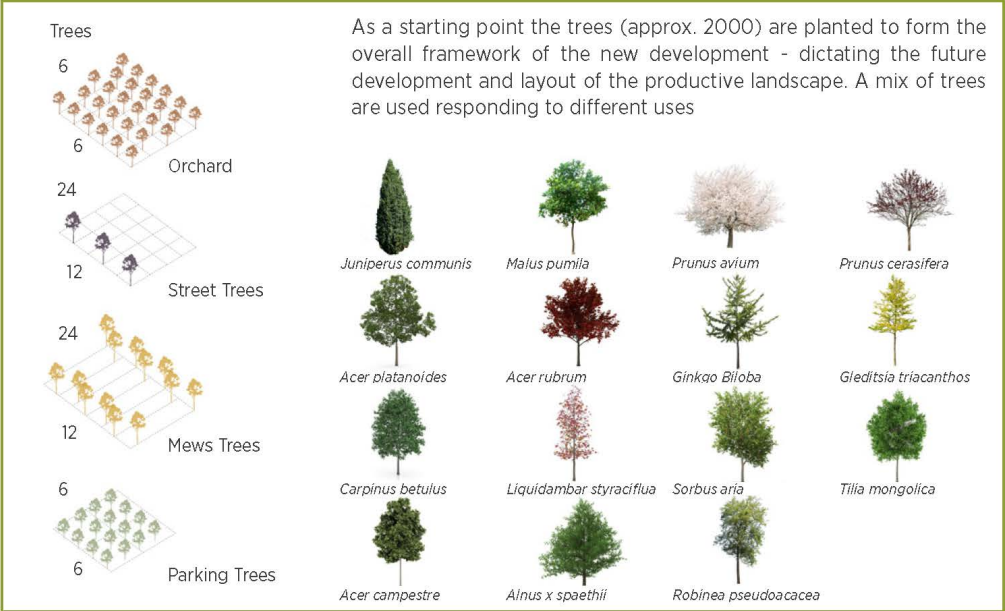

The Framework - The New Trees

HOMES AND COMMUNITY STRUCTURES

CHARACTER AREAS

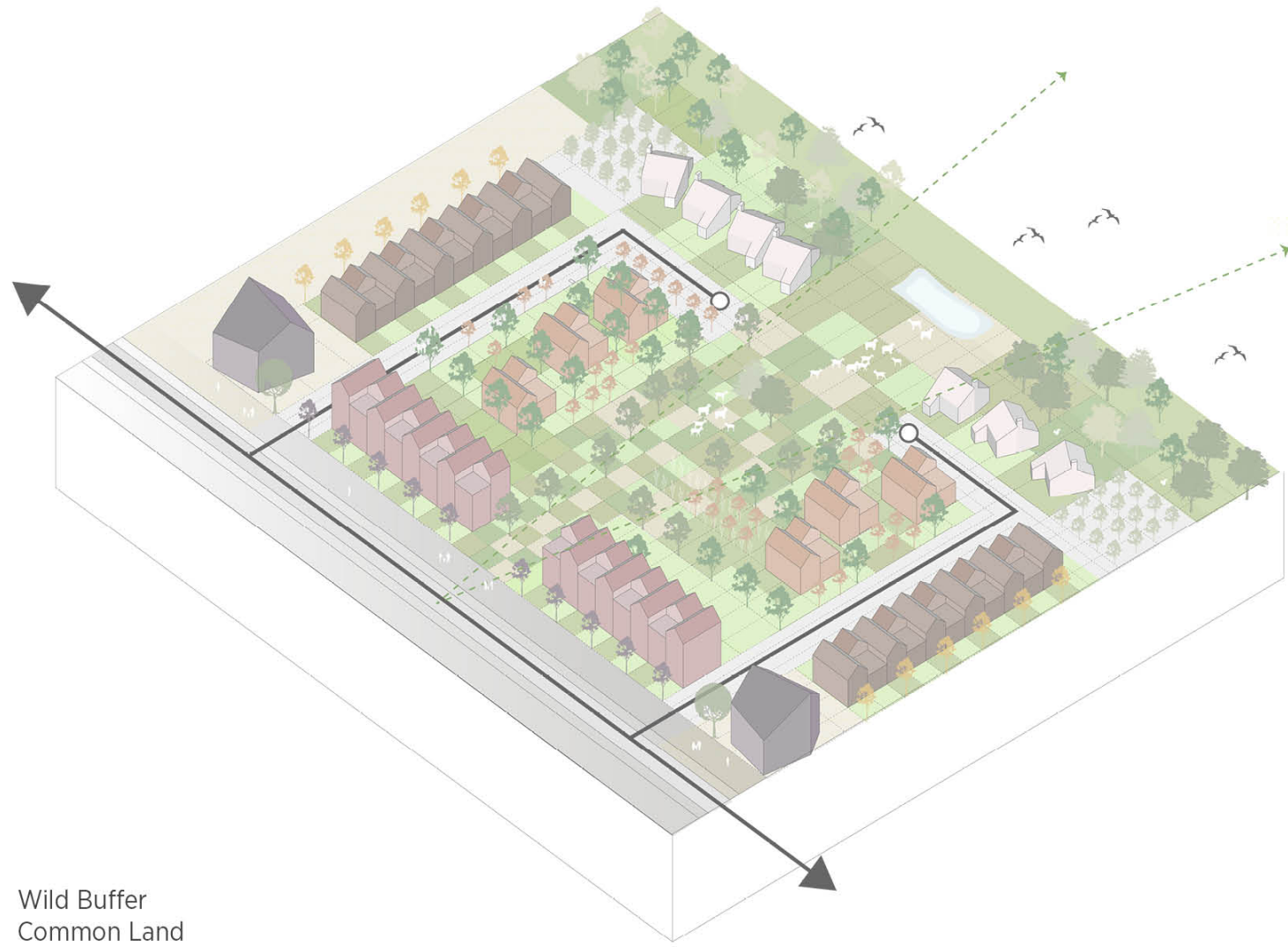

- Detached
- Semi - Detached
- Terraced
- Apartments Avenue
- Apartments Square

- Wild Buffer
- Common Land
- The Mews
- The Avenue
- The Avenue

HOMES AND COMMUNITY STRUCTURES

DETACHED

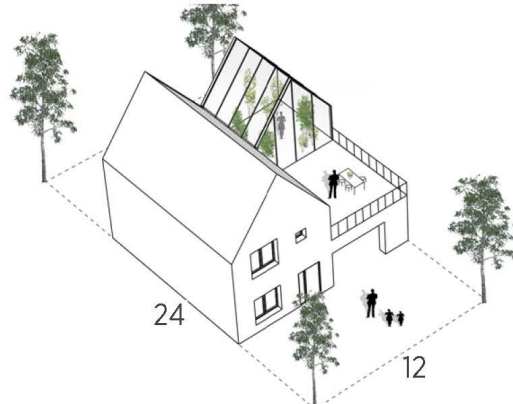

Detached: (25 units/ha) with a single family home on a 12x24m plot.

- Size 3 & 4 Bedroom
- Parking 2 Spaces
- Landscape Front & Rear Garden
- Food production Kitchen Garden & Greenhouse

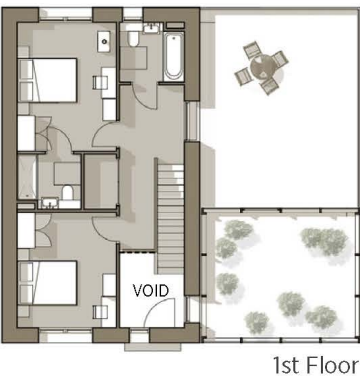

- Detached
- Semi - Detached
- Terraced
- Apartments Avenue
- Apartments Square

The Wild Buffer - Detached

HOMES AND COMMUNITY STRUCTURES

SEMI-DETACHED

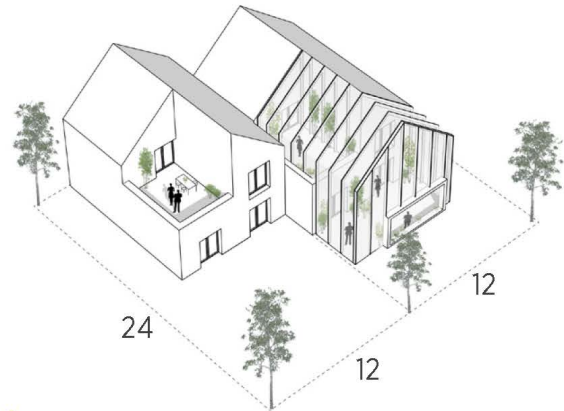

Semi-Detached: (35 units/ha) Semi-detached family homes on a 12x24m plot.

- Size 2 & 3 Bedroom
- Parking 2 Spaces
- Landscape Front & Rear Garden + Terrace
- Food production Garden & Greenhouse

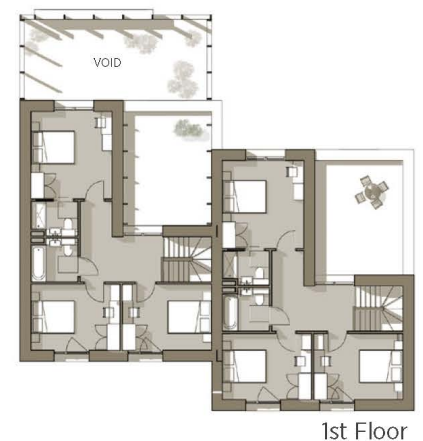

- Detached
- Semi - Detached
- Terraced
- Apartments Avenue
- Apartments Square

The Common - Semi- Detached

HOMES AND COMMUNITY STRUCTURES

TERRACED

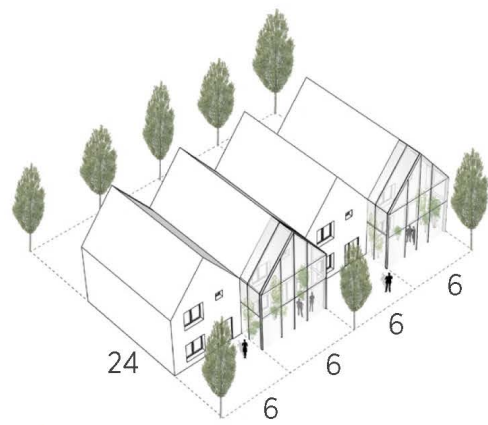

Terraced: (50 units/ha) along the Mews the plots will be subdivided to create 6x24m plots that can be developed for terraced housing to achieve the form of a village street at greater densities.

- Size 2 Bedroom
- Parking 1 Space / 1 Shared
- Landscape Front & Rear Garden + Terrace
- Food production Kitchen Garden & Community Allotment

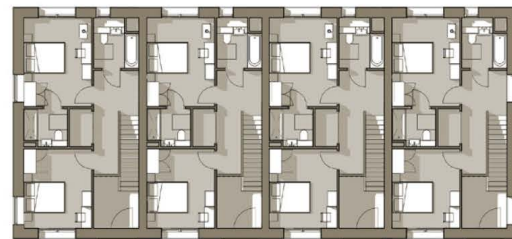
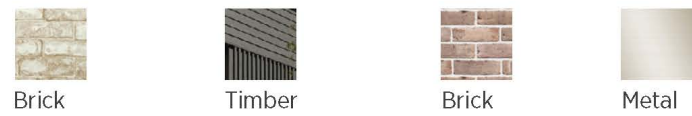

1st Floor



Ground Floor

- Detached
- Semi - Detached
- Terraced
- Apartments Avenue
- Apartments Square

The Mews - Terraced

HOMES AND COMMUNITY STRUCTURES

APARTMENTS

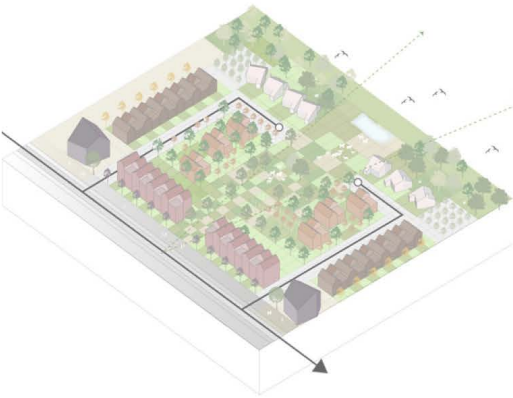

Size 1, 2 & 3 Bedroom
Parking 1/2 Shared
Landscape Rear Garden + Balconies & Roofgarden
Food production Garden & Community Allotment

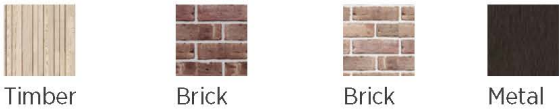

- Detached
- Semi - Detached
- Terraced
- Apartments Avenue
- Apartments Square

Apartments: (100 units/ha) The Avenue plots will be combined to create building sites for small apartment schemes. These will be 3 and 4 storeys and may contain commercial uses on the ground floor.



4th Floor

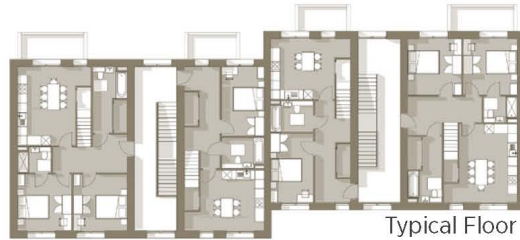

Typical Floor



Ground Floor

The Avenue - Apartments

HOMES AND COMMUNITY STRUCTURES

APARTMENTS

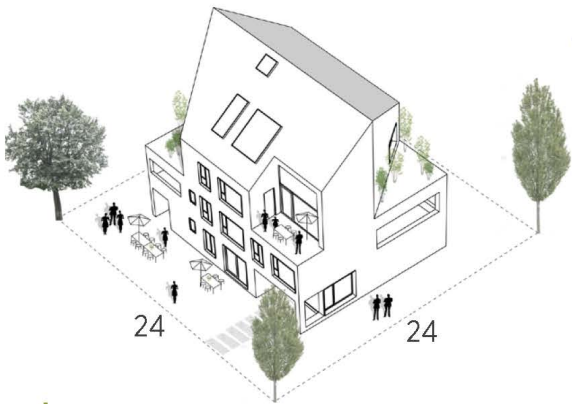

Size
Parking
Landscape
Food production

1 & 2 Bedroom
1/2 Shared
Balconies & Roofgarden
Community Allotment



Tiles



Timber



Metal

Apartments: (100 units/ha) The Square plots will be combined to create building sites for small apartment schemes. These will be 3 and 4 storeys and may contain commercial uses on the ground floor.

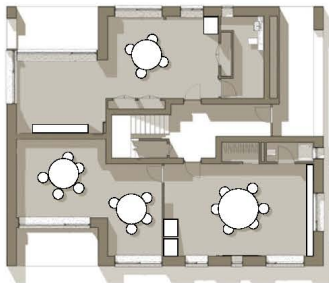

Ground Floor



1. Floor

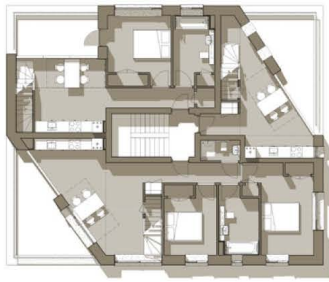

2. Floor

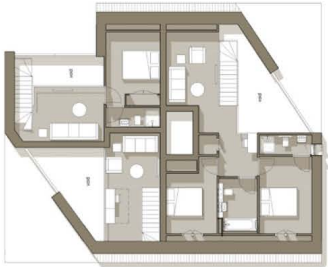

3. Floor

The Square - Apartments / Community

- Detached
- Semi - Detached
- Terraced
- Apartments Avenue
- Apartments Square

HOMES AND COMMUNITY STRUCTURES

STREET CHARACTER/ THE AVENUE

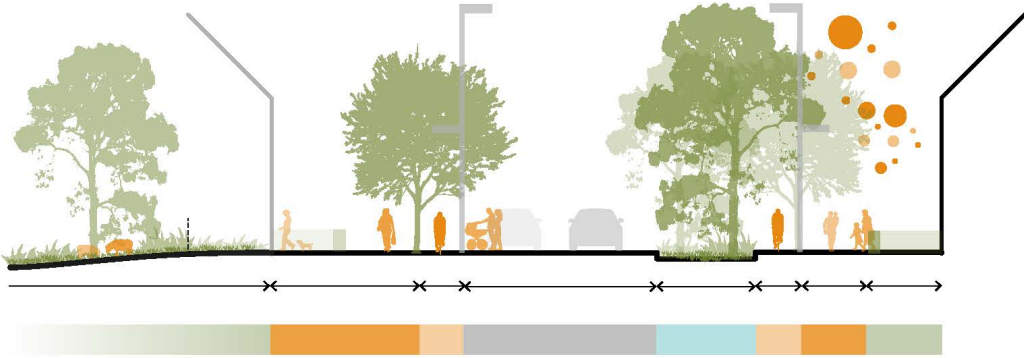
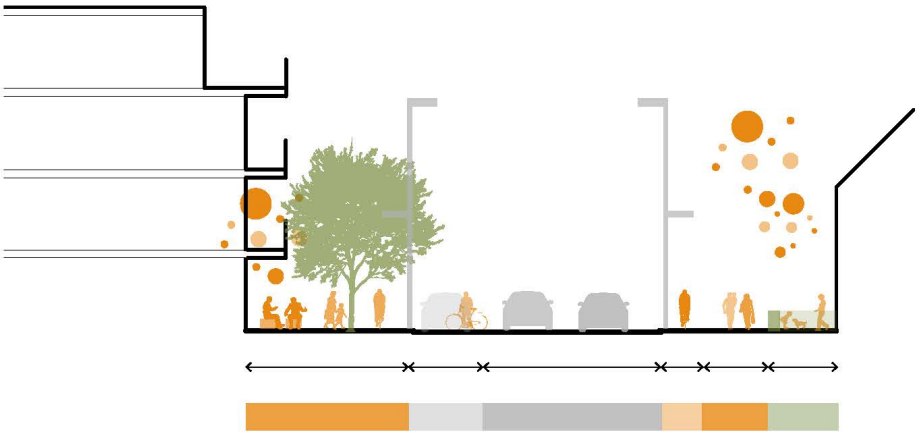
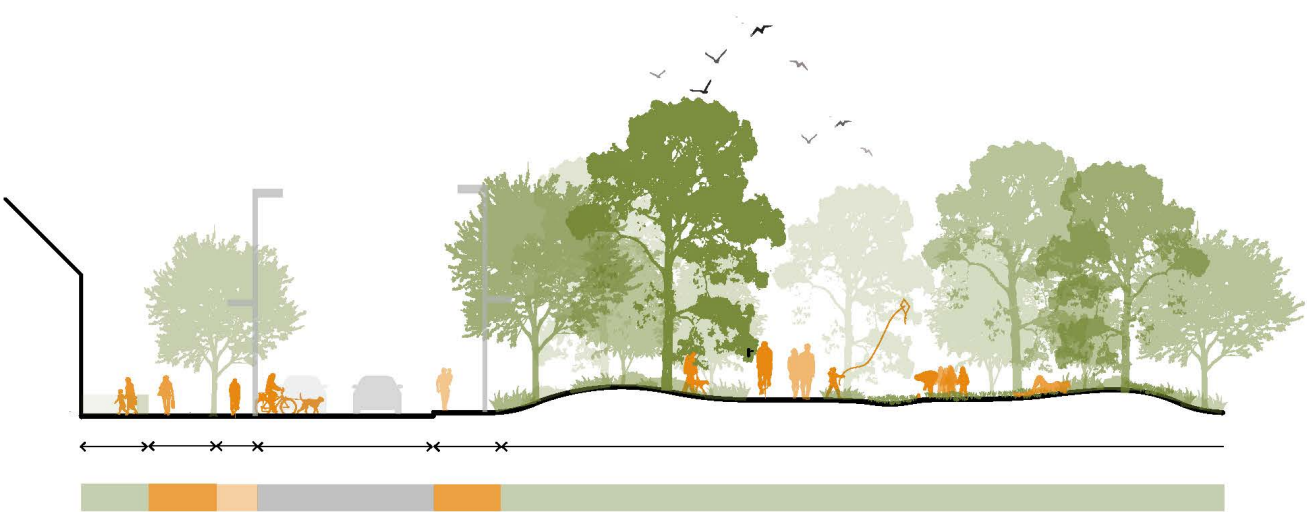
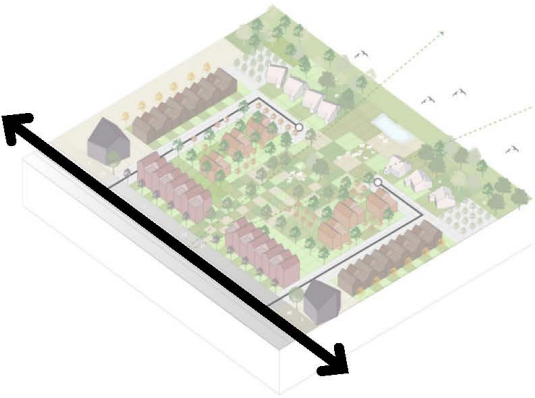

- | | | | |
|---|----------------------------------|---|----------------------------------|
| A | HAMLET | N | TRANSPORT HUB |
| B | MEADOW | O | SCHOOL |
| C | PONDS | P | CARE CENTRE/
SENSORY GARDENS |
| D | CAR-FREE MEWS | Q | SELF-BUILD |
| E | SHARED PARKING | R | FLEXIBLE STRUCTURES
(PARKING) |
| F | COMMUNAL SQUARE | | |
| G | AVENUE | | |
| H | COMMUNITY FARM /
AGROFORESTRY | | |
| I | RAIN GARDENS | | |
| J | HEDGEROWS | | |
| K | PARKWAY | | |
| L | ORCHARDS | | |
| M | WILD BUFFER | | |





